

PROFESSIONAL ENGINEER FOR
ALLEN & MAJOR ASSOCIATES, INC.

REV	DATE	DESCRIPTION

APPLICANT/OWNER:
JBC REALTY TRUST LLC
18 BAYSHORE DRIVE
MERIDETH, NH 03253

PROJECT:
STATE LINE CONVENIENCE
BUILDING ADDITION
44 ROUTE 13
BROOKLINE, NH 03033

PROJECT NO.: 182011 **DATE:** 08-14-20
SCALE: 1" = 30' **DRAWN BY:** C182011.dwg
CHECKED BY: MJC

ALLEN & MAJOR ASSOCIATES, INC.
civil, structural & landscape architecture
environmental consulting • landscape architecture
www.aandmajor.com
400 HARTLEY ROAD
MANCHESTER, NH 03104
TEL: 603-482-5500
FAX: 603-482-5501

WORKS IN: MA • ILLINOIS • NH • VERMONT • VT • MASSACHUSETTS • NH

THIS DRAWING AND ANY INSTRUMENTS OF SERVICE HEREAFTER PREPARED BY OR FOR THE FIRM ARE THE PROPERTY OF ALLEN & MAJOR ASSOCIATES, INC. AND ARE NOT TO BE REPRODUCED, COPIED, REPRODUCED, OR TRANSMITTED IN ANY FORM OR BY ANY MEANS, ELECTRONIC OR MECHANICAL, INCLUDING PHOTOCOPYING, RECORDING, OR BY ANY INFORMATION STORAGE AND RETRIEVAL SYSTEM, WITHOUT THE WRITTEN PERMISSION OF ALLEN & MAJOR ASSOCIATES, INC. ANY REPRODUCTION OR TRANSMISSION OF THIS DRAWING OR INSTRUMENT OF SERVICE WITHOUT THE WRITTEN PERMISSION OF ALLEN & MAJOR ASSOCIATES, INC. SHALL BE AT THE USER'S SOLE RISK AND WITHOUT LIABILITY TO ALLEN & MAJOR ASSOCIATES, INC.

DRAWING TITLE: FIRE TRUCK TURNING PLAN **SHEET NO.:** C-104

Copyright © 2020 Allen & Major Associates, Inc.

R:\PROJECTS\1820-11\LOCAL\DRAWINGS\CURRENT\C-C-1820-11_FIRETRUCK_TURNING_PLAN.dwg

DIG SAFE
BEFORE YOU DIG
CALL 811 OR
1-888-DIG-SAFE
1-888-344-7233

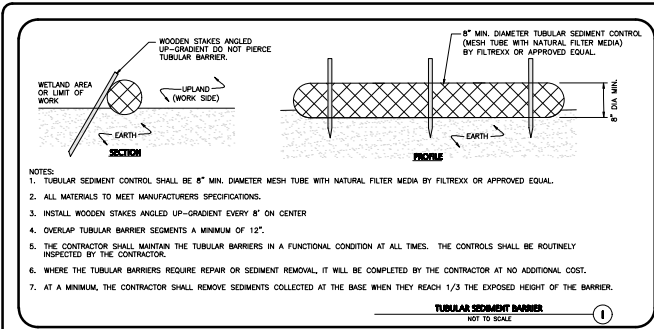

STANDARD DUTY FLEXIBLE PAVEMENT DESIGN SECTION

LAYER NUMBER	LAYER DESCRIPTION	LAYER THICKNESS (INCHES)
1	BITUMINOUS WEARING COURSE (8" AGGREGATE - IN HOT PRE-APPROVED MIX DESIGN)	1.5"
2	BITUMINOUS BINDER COURSE (8" AGGREGATE - IN HOT PRE-APPROVED MIX DESIGN)	2.0"
3	CRUSHED GRANULAR (BASE COURSE)	6.0"
4	GRAVEL BORROW (SUBBASE COURSE) (IN HOT MIX SHALE)	6.0"
5	CLEAN GRANULAR FILL MATERIAL OR APPROVED ON-SITE MATERIALS (SUBGRADE)	AS NECESSARY

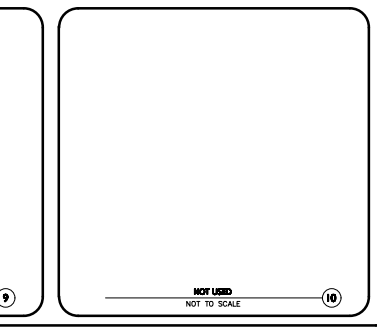
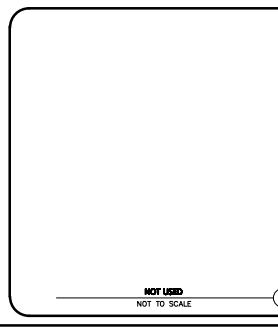
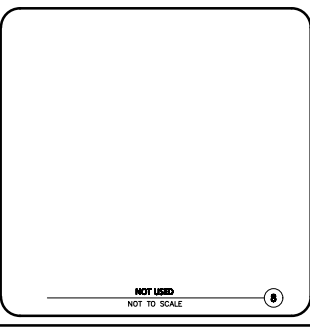
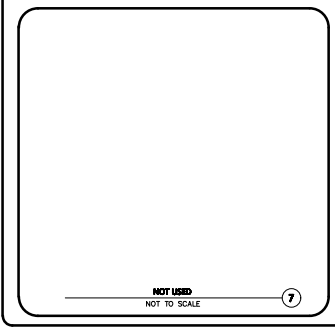
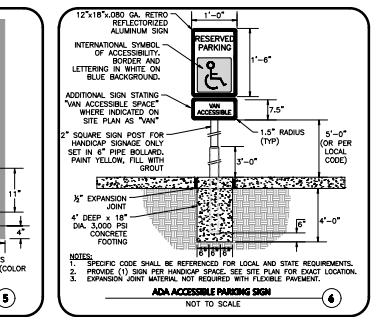
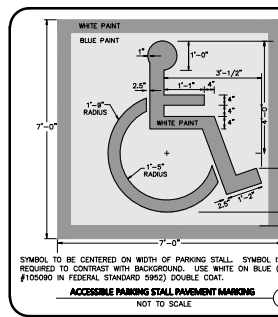
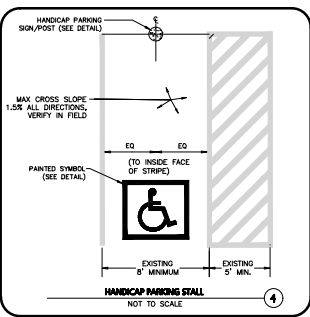
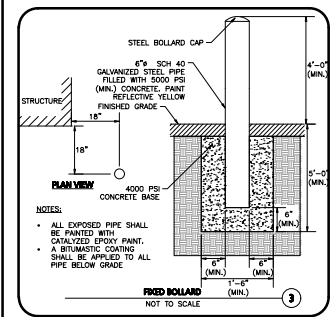
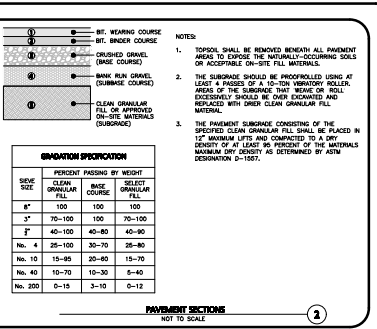

Professional Engineer for ALLEN & MAJOR ASSOCIATES, INC.

STATE LINE CONVENIENCE BUILDING ADDITION
44 ROUTE 13
BROOKLINE, NH 03033

PROJECT NO. 182011 DATE: 08-14-20
SCALE: AS SHOWN DATE: 08-14-20
DESIGNED BY: SM CHECKED BY: SM

ALLEN & MAJOR ASSOCIATES, INC.
1001 INDUSTRIAL BLVD SUITE 200
MANTONVILLE, NH 03053
TEL: 603-825-5500 FAX: 603-825-5501

DRAWING TITLE: **DETAILS** SHEET NO. **C-501**

R:\PROJECTS\182011\CAD\DRAWINGS\CURRENT\C-501-D-DETAILS.DWG

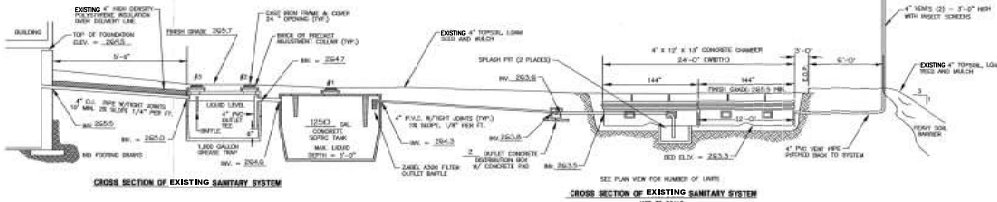

PREVIOUSLY APPROVED SYSTEM SIZING

DATE: 10/15/03

PROJECT: 18 BAYSHORE DRIVE, BROOKLINE, NH 03033

CLIENT: JBC REALTY TRUST LLC

DESIGNER: ALLEN & MAJOR ASSOCIATES, INC.

PREVIOUSLY APPROVED LOT LOADING

NOTES:

LOT LOADING CALCULATION:

TOTAL OF AREA OF 270 SQ. FT.

PERmitted LOAD = 1.5 GPD / SQ. FT.

ALLOWED LOAD = 405 GPD

EXISTING SYSTEM CAPACITY = 32 UNITS

RECOMMENDED SYSTEM CAPACITY = 32 UNITS

- PLAN REFERENCES**
- EXISTING CONDITIONS & TOPOGRAPHIC INFORMATION BASED UPON PLAN DATED 10/15/03.
 - SYSTEM #1: 18 BAYSHORE DRIVE, BROOKLINE, NH 03033.
- GENERAL NOTES**
- THE INTENT OF THIS PLAN IS TO INCREASE THE PERMITTED FLOW TO SYSTEM #1 PREVIOUSLY APPROVED UNDER APPROX. 1.5 GPD / SQ. FT. TO 3.0 GPD / SQ. FT. TO ACCOMMODATE THE INCREASED FLOW OF THE PROPOSED SYSTEM AND CORRECTLY COVERED LOADING DOCK.
 - THE INFORMATION SHOWN ON THIS PLAN IS THE SOLE PROPERTY OF ALLEN & MAJOR ASSOCIATES, INC. IT'S INTENTED USE IS TO PROVIDE INFORMATION FOR CONSTRUCTION OF THE PROPOSED SYSTEM. NO OTHER USES ARE INTENDED WITHOUT THE EXPRESS WRITTEN CONSENT OF ALLEN & MAJOR ASSOCIATES, INC. IT'S STRICTLY PROHIBITED.

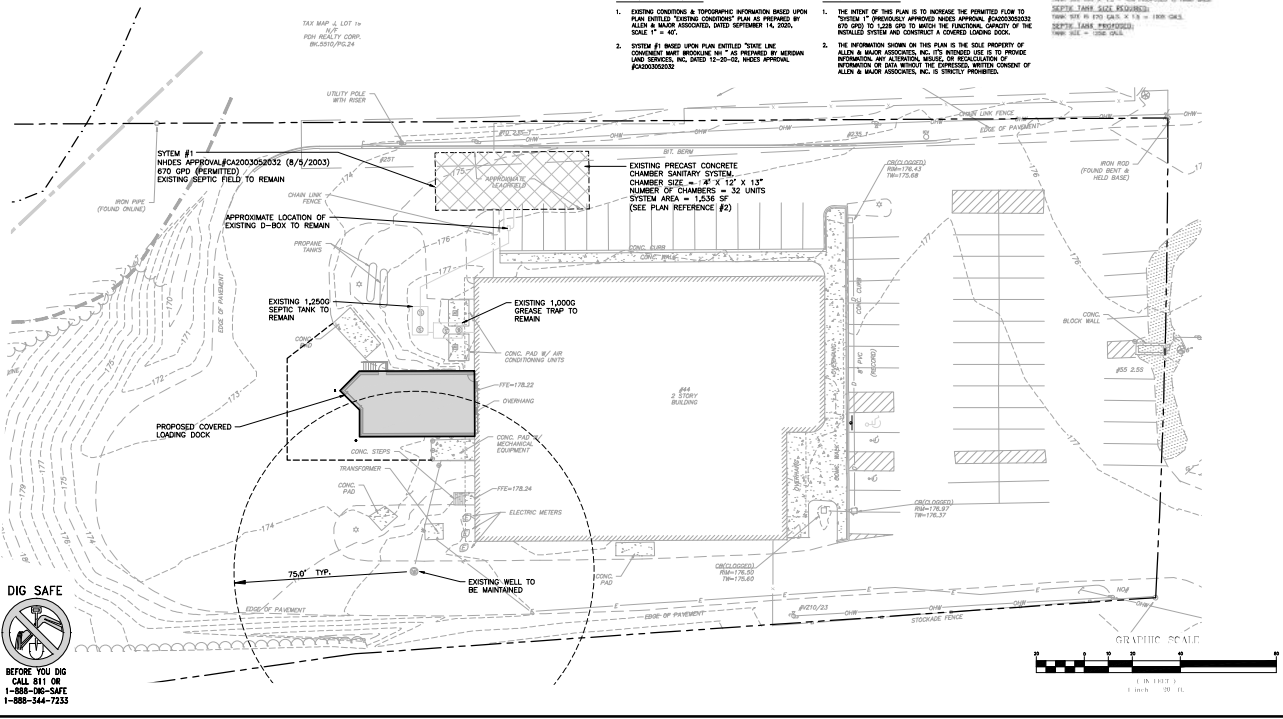

ALLEN & MAJOR ASSOCIATES, INC.

REGISTERED PROFESSIONAL ENGINEER

NO. 10000

STATE OF NEW HAMPSHIRE

18 BAYSHORE DRIVE, BROOKLINE, NH 03033

DATE: 10/15/03

PROJECT: 18 BAYSHORE DRIVE, BROOKLINE, NH 03033

CLIENT: JBC REALTY TRUST LLC

DESIGNER: ALLEN & MAJOR ASSOCIATES, INC.

STATE LINE CONVENIENCE BUILDING ADDITION

44 ROUTE 13

BROOKLINE, NH 03033

PROJECT NO. 18B0311 DATE: 08-14-03

SCALE: 1" = 20' DATE: 10/15/03

DRAWN BY: MAM CHECKED BY: MAM

ALLEN & MAJOR ASSOCIATES, INC.

18 BAYSHORE DRIVE, BROOKLINE, NH 03033

TEL: 603-882-5000 FAX: 603-882-5001

WORKSHEET: 18B0311-1

INDIVIDUAL SUBSURFACE DISPOSAL SYSTEM

ISDS-1

R:\PROJECTS\18B0311\CAD\DWG\18B0311-1-SEPTIC.DWG